

- GB** Assembly and wiring of SIRCO PV.
- F** Montage et câblage des SIRCO PV.
- E** Montaje y conexión de los SIRCO PV.

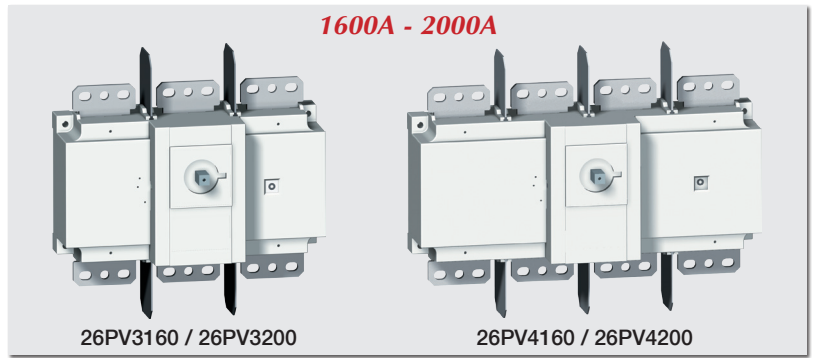

**Switch and accessories**  
**L'interrupteur et ses accessoires**  
**El interruptor y sus accesorios**

Edition 10/12 - RECTO-VERSO / S blanc offset 80g/m² / QUADRI

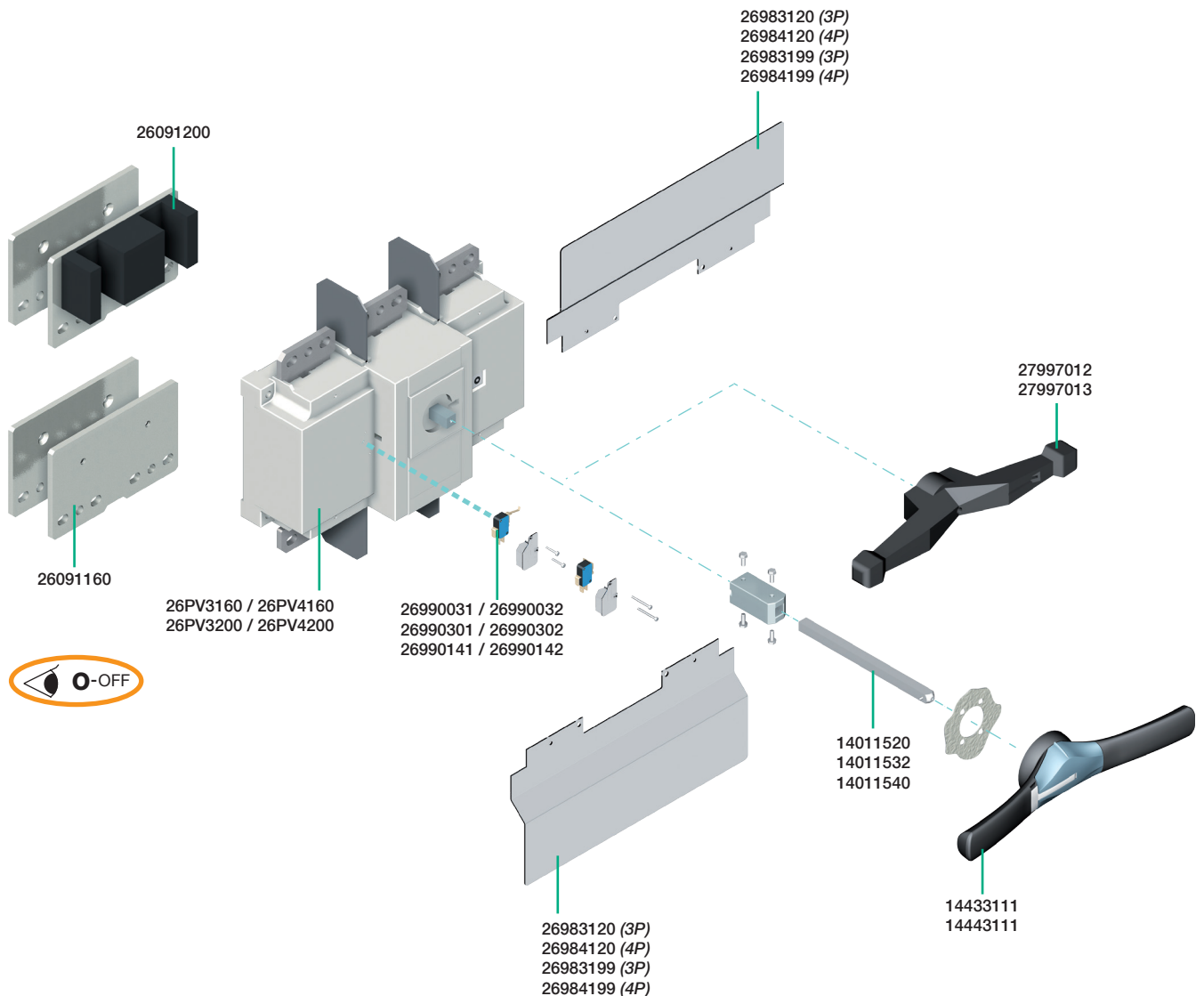

**⚠ DANGER / DANGER / PELIGRO**

**HAZARDOUS VOLTAGE** . This equipment must be installed and serviced only by qualified electrical personnel. Turn off all power supplying this equipment before working on or inside equipment. Always use a properly rated voltage sensing device to confirm power is off. Replace all devices, doors, and covers before turning on power to this equipment. **Failure to follow these instructions will result in death or serious injury.**

**TENSION DANGEREUSE**. L'installation et l'entretien de cet appareil ne doivent être effectués que par du personnel qualifié. Coupez l'alimentation de cet appareil avant d'y travailler. Utilisez toujours un dispositif de détection de tension à valeur nominale approprié pour confirmer que toute alimentation est coupée. Remplacez tous les dispositifs, les portes et les couvercles avant de mettre cet appareil sous tension. **Si ces précautions ne sont pas respectées, cela entraînera la mort ou des blessures graves.**

**TENSION PELIGROSA**. Solamente el personal de mantenimiento eléctrico especializado deberá instalar y prestar servicios de mantenimiento a este equipo. Desenergice el equipo antes de realizar cualquier trabajo en él. Siempre utilice un dispositivo detector de tensión adecuado para confirmar la desenergización del equipo. Vuelva a colocar todos los dispositivos, las puertas y las cubiertas antes de energizar este equipo. El incumplimiento de estas precauciones podrá causar la muerte o lesiones serias.

- ❶ 26PV3160
- ❷ 26PV4160
- ❸ 26PV3200
- ❹ 26PV4200

Dual dimensions in/mm  
 Double dimensions in/mm  
 Doble dimensiones in/mm

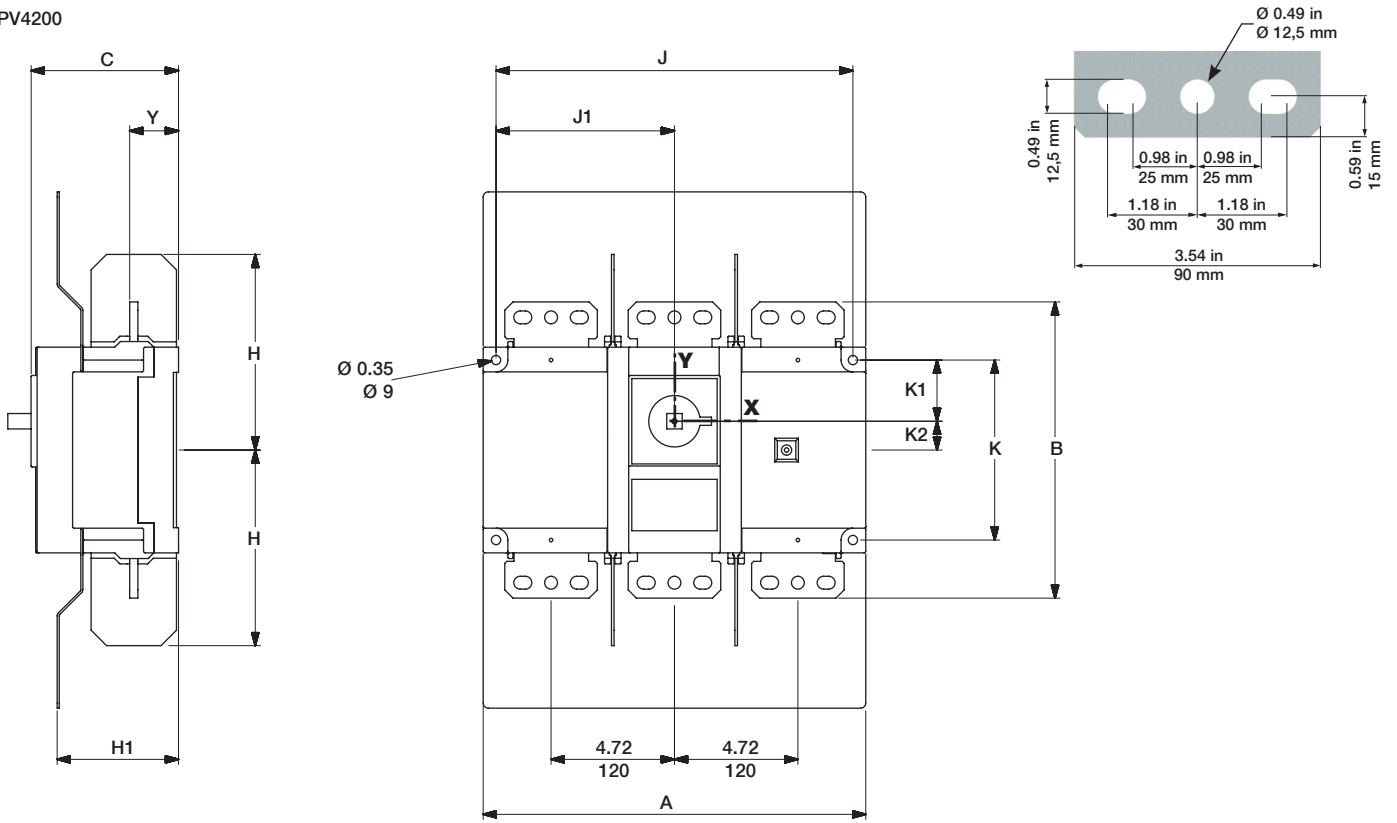

		A		B		C		H		H1		J		J1		K		K1		K2		Y	
		in	mm	in	mm	in	mm	in	mm	in	mm	in	mm	in	mm	in	mm	in	mm	in	mm	in	mm
❶	3P	14.65	372	11.34	288	5.65	143.5	7.48	190	3.74	95	13.66	347	6.83	173.5	6.89	175	2.83	72	1.1	28	1.87	47.5
❷	4P	19.37	492	11.34	288	5.65	143.5	7.48	190	3.74	95	18.39	467	9.19	233.5	6.89	175	2.83	72	1.1	28	1.87	47.5
❸	3P	14.65	372	11.34	288	5.65	143.5	7.48	190	4.69	119	13.66	347	6.83	173.5	6.89	175	2.83	72	1.1	28	1.87	47.5
❹	4P	19.37	492	11.34	288	5.65	143.5	7.48	190	4.69	119	18.39	467	9.19	233.5	6.89	175	2.83	72	1.1	28	1.87	47.5

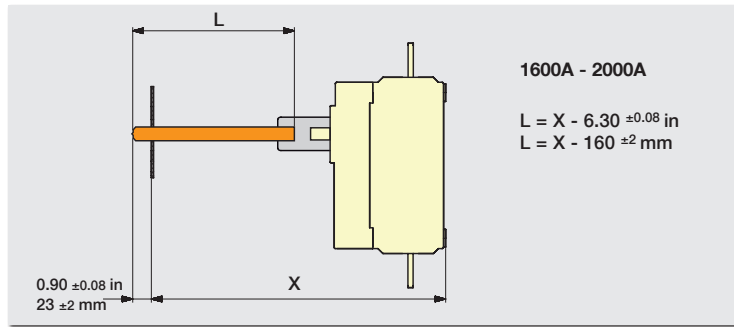

Mounting orientation / Sens de montage / Sentido de montaje

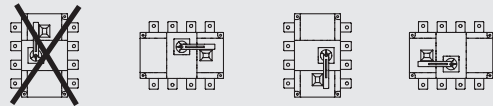

Mounting of terminal covers  
 Montage des capots  
 Montaje de los Cubrebornes

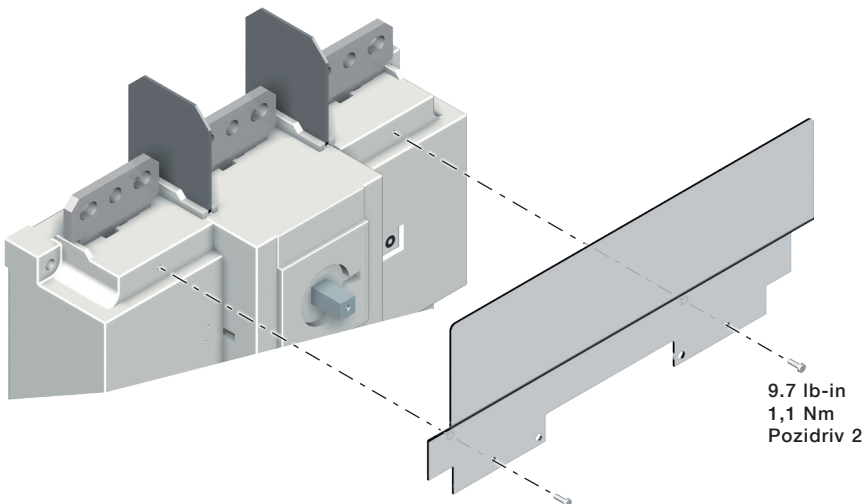

	Ref. TOP	Ref. BOTTOM
	Ref. AMONT Referencia SUPERIOR	Ref. AVAL Referencia INFERIOR
❶ 26PV3160	26983120	26983120
❷ 26PV4160	26984120	26984120
❸ 26PV3200	26983199	26983199
❹ 26PV4200	26984199	26984199



**Mounting of auxiliary contacts**  
**Montage des contacts auxiliaires**  
**Montaje de los contactos auxiliares**

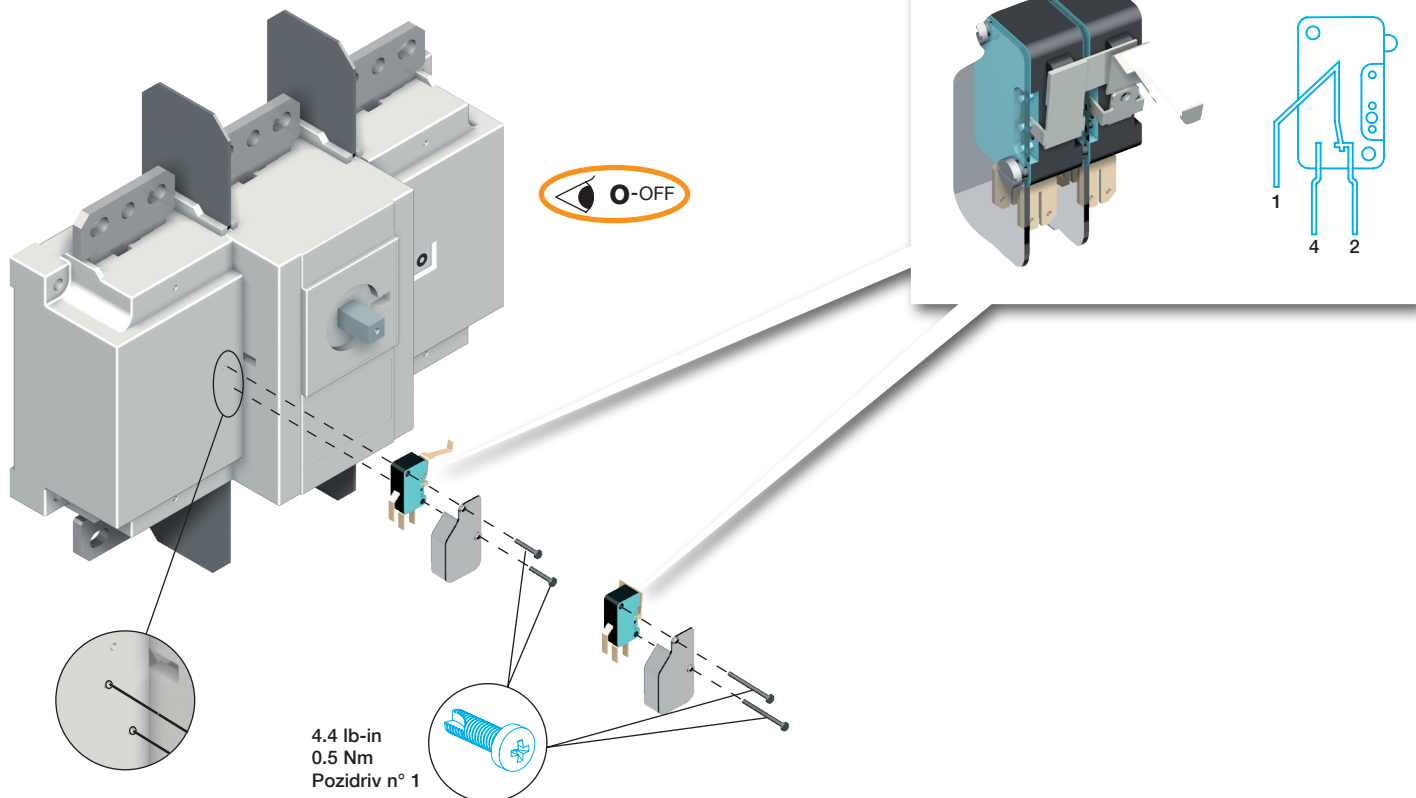

**Mounting of jumpers (for poles in series)**  
**Montage des barres de pontage (pour pôles en série)**  
**Montaje de las pletinas de union (conexión de los polos en series)**

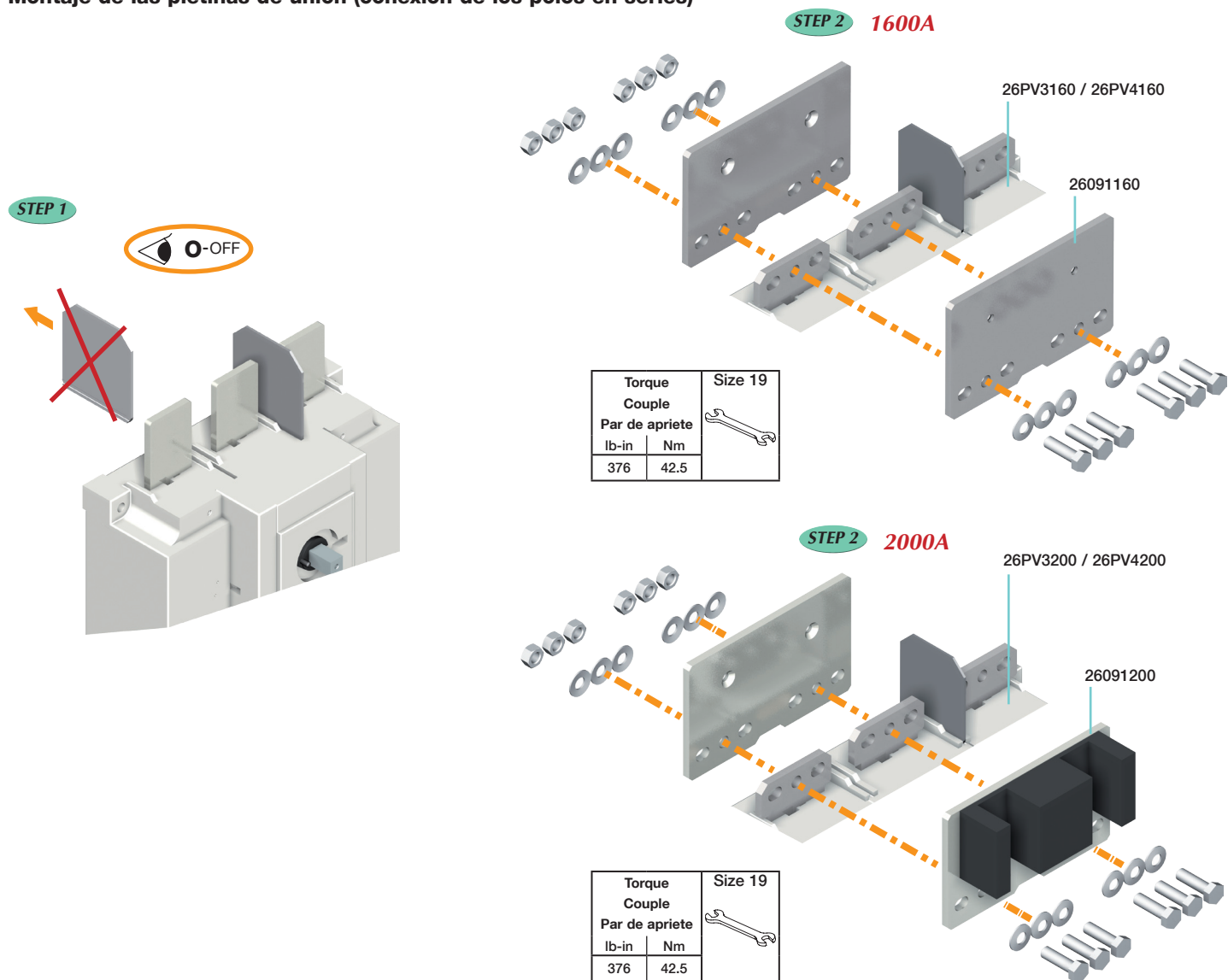

26PV3160  
26PV3200  
26PV4160  
26PV4200

750 Vdc

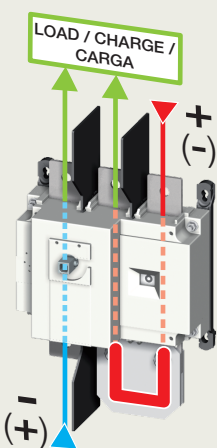
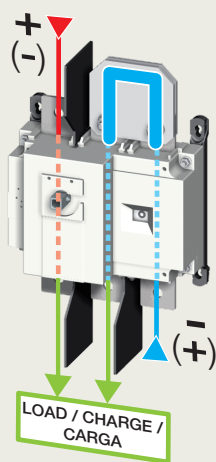
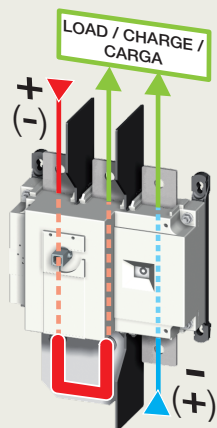
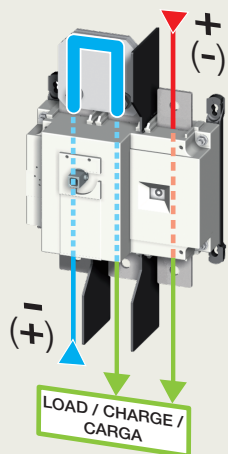

Please note that in some installation standards, this configuration might not be allowed.

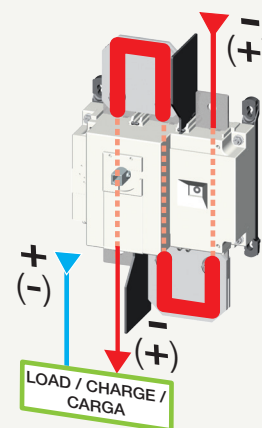
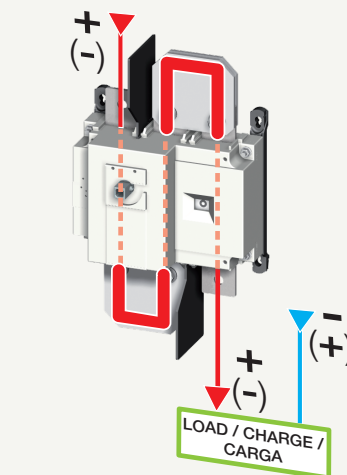

26PV4160  
26PV4200

1000 Vdc

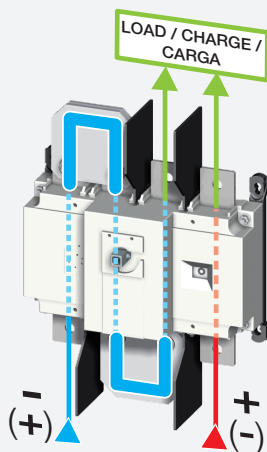
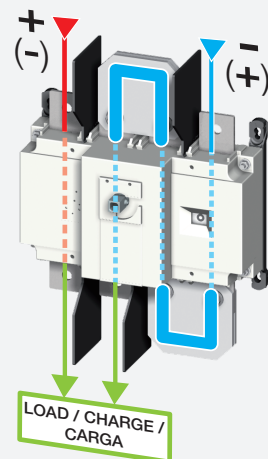

Please note that in some installation standards, this configuration might not be allowed.

